

# W500E

## 安裝說明&零件手冊 Instruction Book

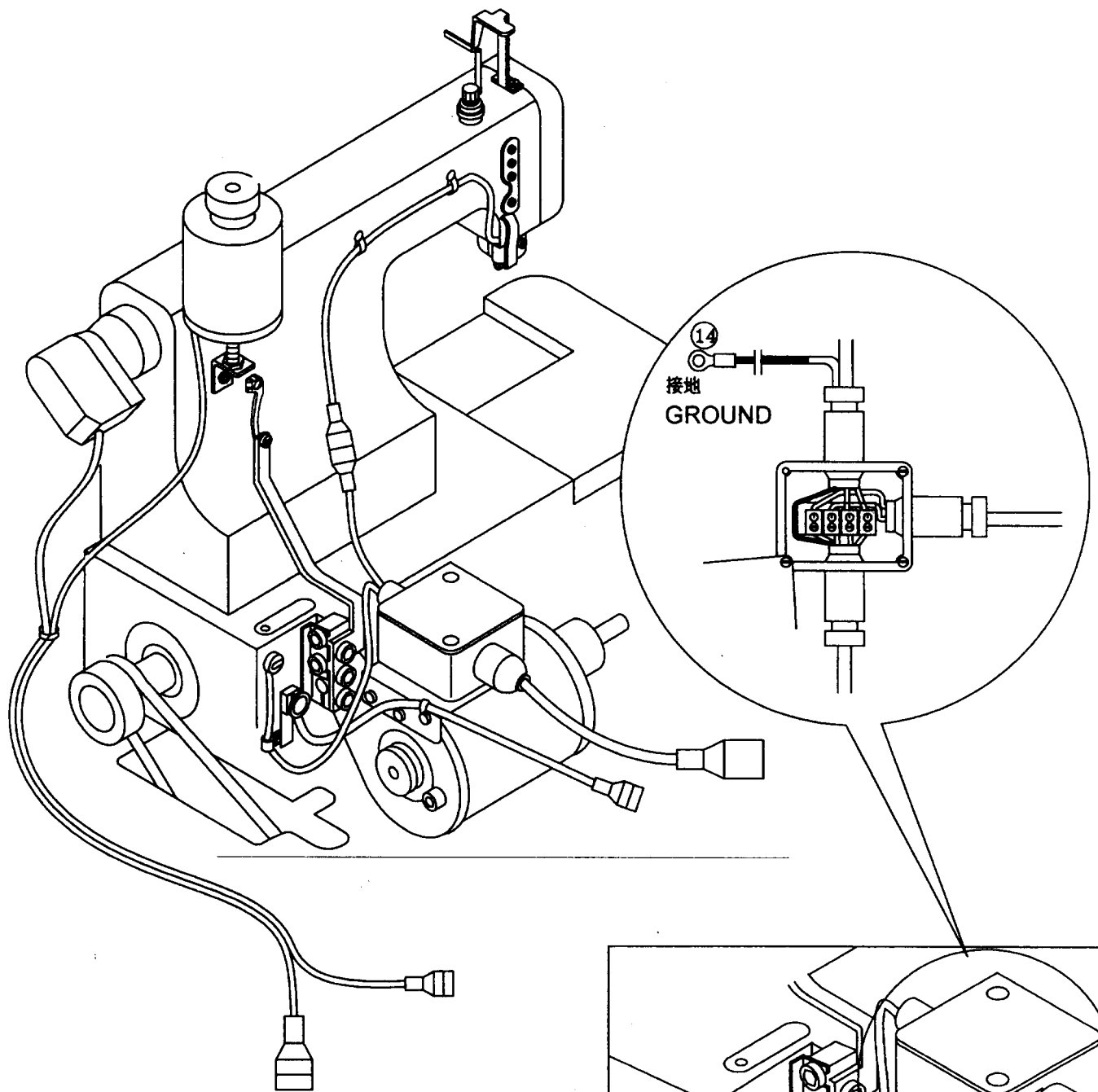

### 自動切刀切線圖

請參考圖示，將接線端子接地線 14，黃色及綠色條紋，並請使用固定夾 15 固定。

Electrical Wiring Diagram :

Please follow the drawing to install the Electrical Wiring. To use the terminal connect the ground wire (14) which color are stripe yellow & green. To fix the ground wire by fixed clamp (15). then, To switch off the electric power.

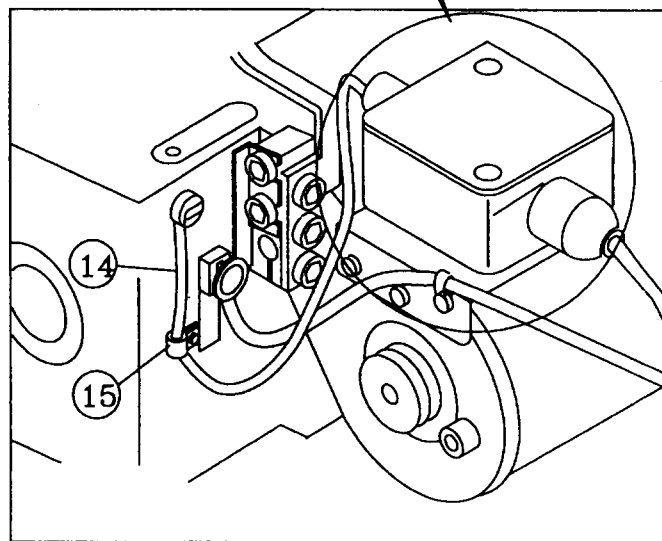

# 鬆線組安裝

1. 取下原張力調整組⑧及連桿①,②。
2. 將連桿③置入連桿孔中與曲柄④連接，螺絲⑤暫不鎖緊。
3. 將配件⑥以螺絲⑦固定。
4. 將組合後之張力調整組鎖回原位，圖一中接合處以E形扣環固定。

## Installation of Tension Disc Separator :

1. Take the original tension disc unit (8) and connecting rod (1),(2) out.
2. To put the connecting rod into the hole of connecting rod for joining the crank. Please don't tight the screw (5) down.
3. Please fix the accessory (6) down by screw (7).
4. Put the assembled Tension Disc Separator unit back to the original position and be joined by retaining ring. (Fig. 1)

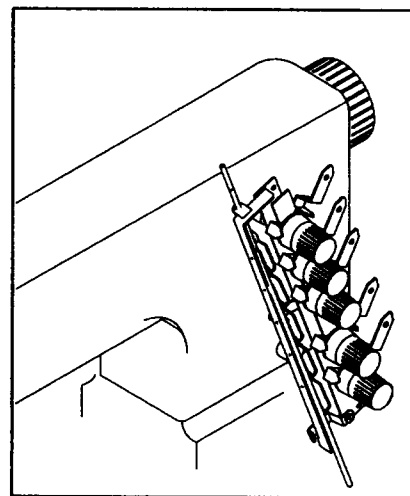
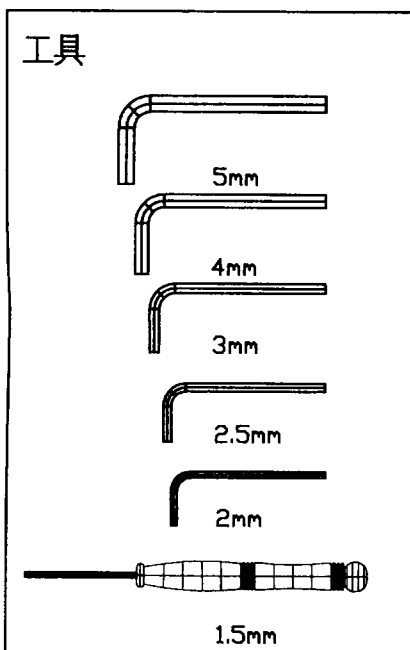
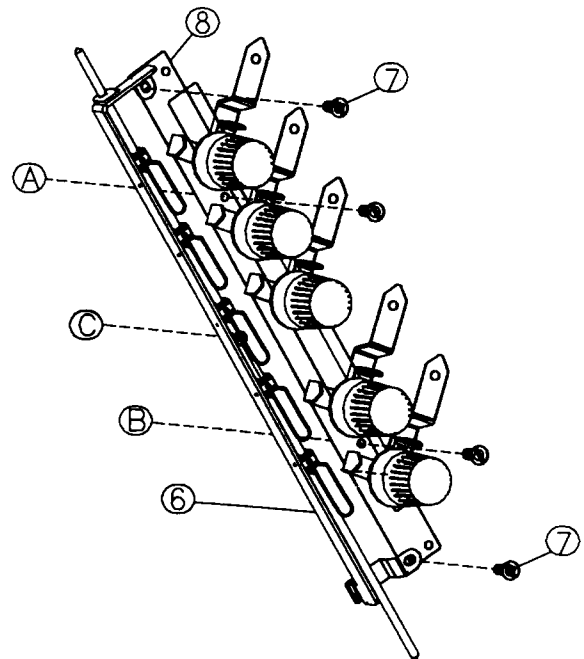
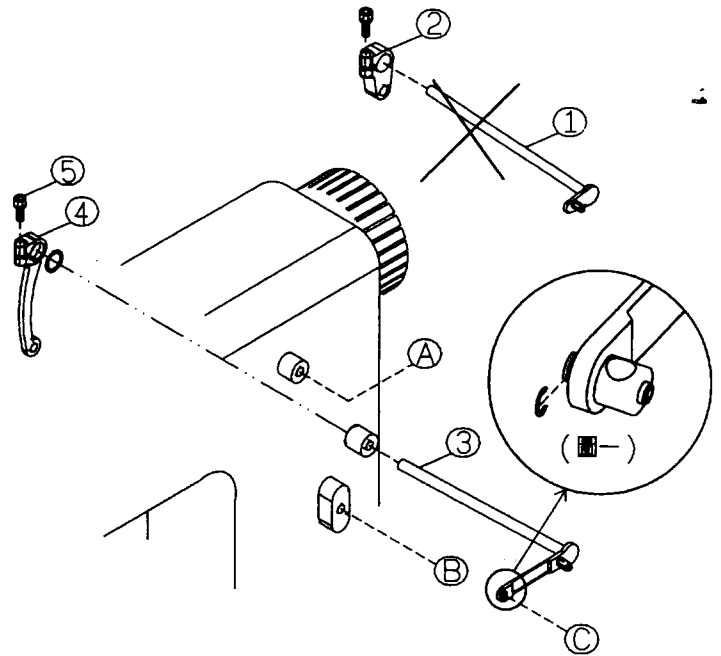

## 下切刀組的安裝方法

請參考圖示，依照①、②的順序安裝。安裝後，請輕搖臂桿③確認。

### ◎切刀切斷動作的確認

請使用一條毛線確認切刀切斷的動作。如切斷的效果不好時，則請調整彈片④。

### Installation of Lower Thread Trimmer :

1. Please refer to the drawing and follow the order(1).(2) to install the "Lower Thread Trimmer". Please move the lower knife driving lever (3) to double check the installation.
2. To double confirm the cutting result - Please take a thread to test the cutting result. If the cutting result isn't good, Please adjust the clamp spring (4).

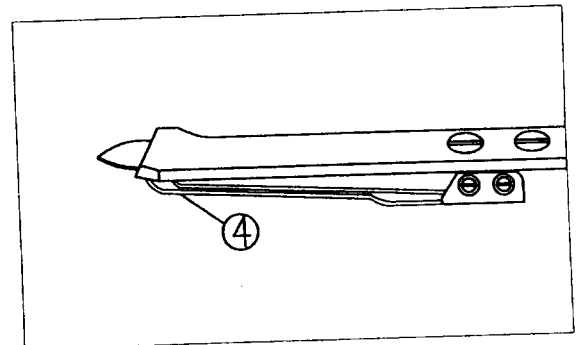
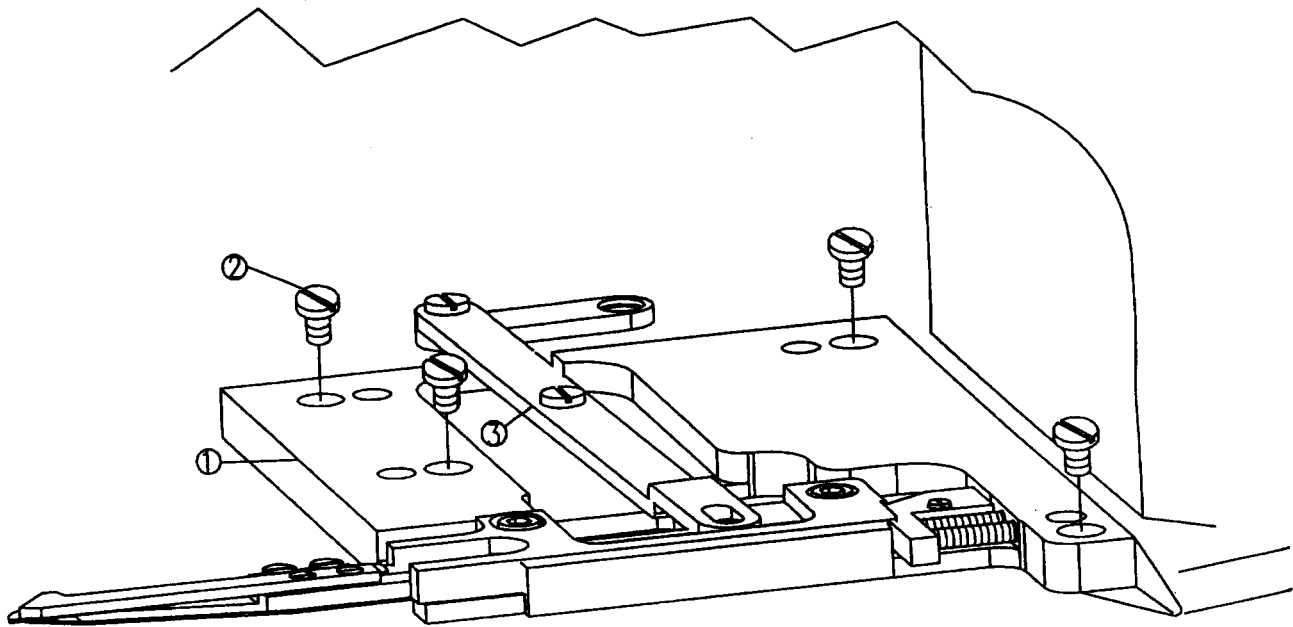

## 下切刀座的安裝方法

### Installation of Lower Knife

#### Holder :

1. 固定座⑨的端面到固定刀⑩的端面之間的距離為167mm的位置處。

在W500的機型時

固定刀刀刃至彈片⑪頂端之距離為0.3mm處。

The distance from end of Fixed Knife Holder (9) to end of Fixed Knife (10) is 167 mm.

For W500 series, The difference between the blade of Fixed Knife to the tip of Clamp Spring is 0.3 mm.

2. 固定桿⑫之頂端與活動刀⑬刀刃之間的距離為163.5mm，並請固定桿與活動刀平行時安裝。

The distance from end of Moving Knife Holder to the tip of Moving Knife is 163.5 mm., Please install the Moving Knife and Holder in parallel.

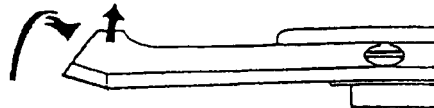

- ◎將切刀的前端往箭頭的方向稍微旋轉，則其剪切的效果會較好。

To turn the front parts of Fixed Knife to arrowhead way, It's going to get a perfect cutting.

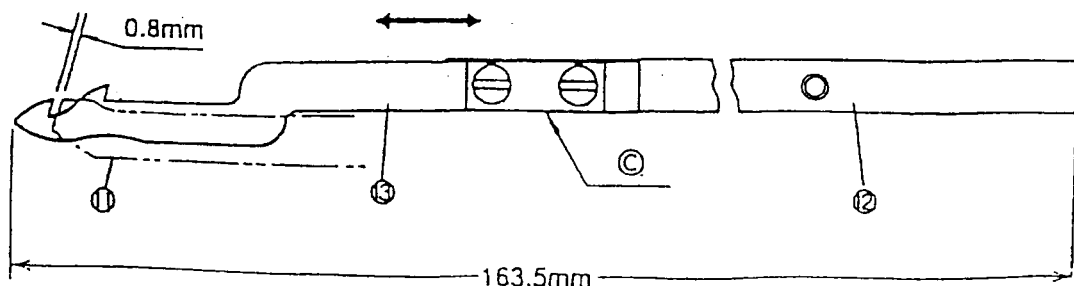
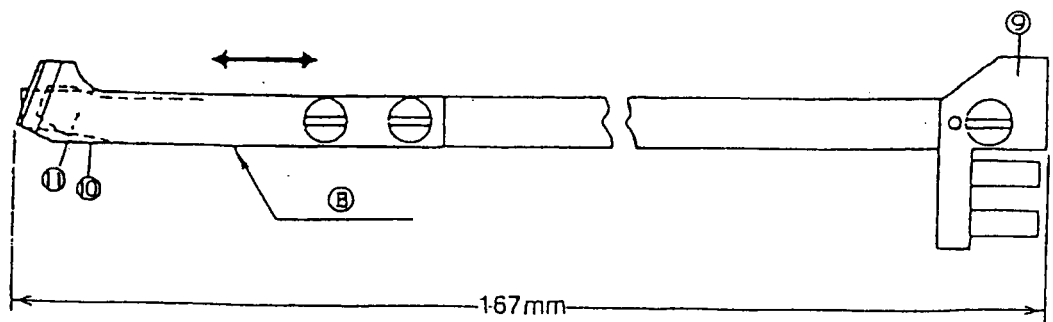
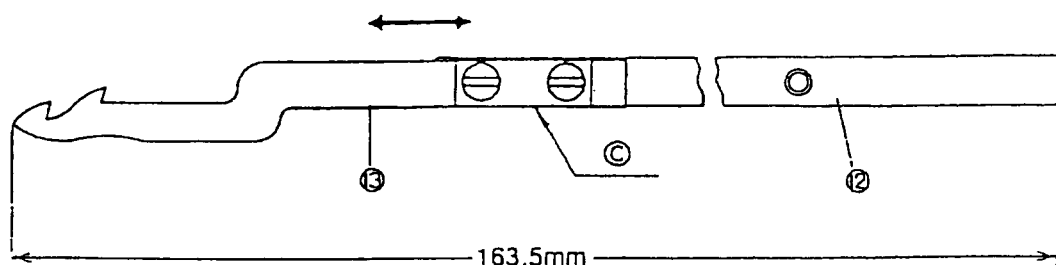
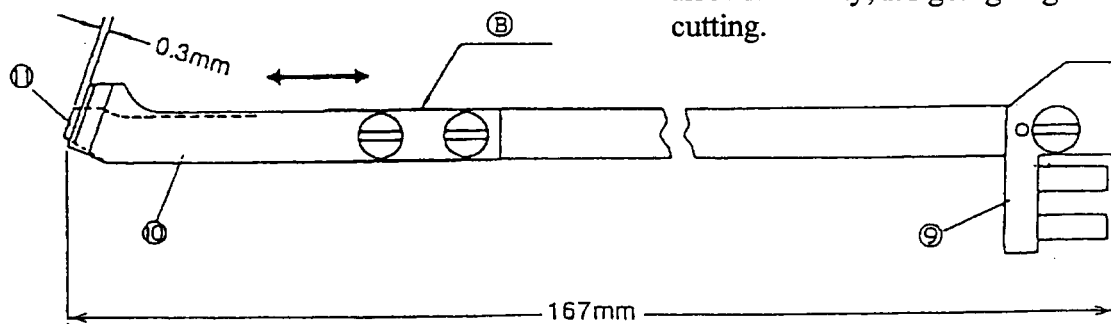

## 電磁鐵組安裝方法

1. 請參考圖示, 依照1, 2的順序, 請在軸心座7 與車體的上端在同一高度, 在水平位置處安裝(如圖※所示)。
2. 電磁鐵行程的調整  
請取下橡膠蓋3, 並將螺帽4 放鬆, 以螺帽5 將行程調整為17.9mm。
3. 電磁鐵固定位置的調整  
請將電磁鐵固定架6 的端面至軸心座7 的A面之間的距離調整為117.5mm。  
彈簧8 在未固定狀態時, 請確定軸心7 是否能輕輕搖動。

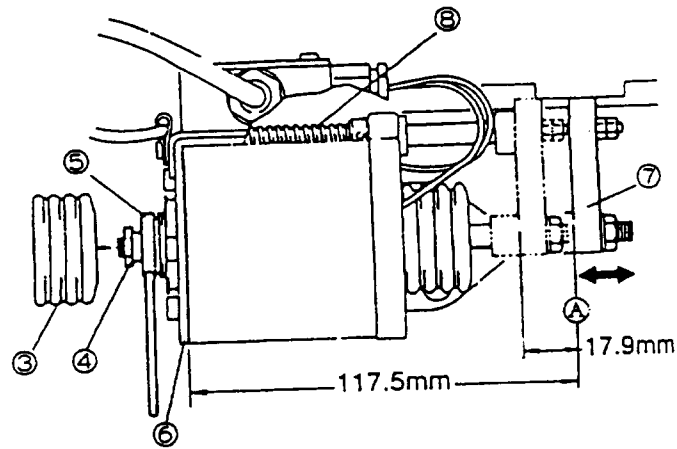
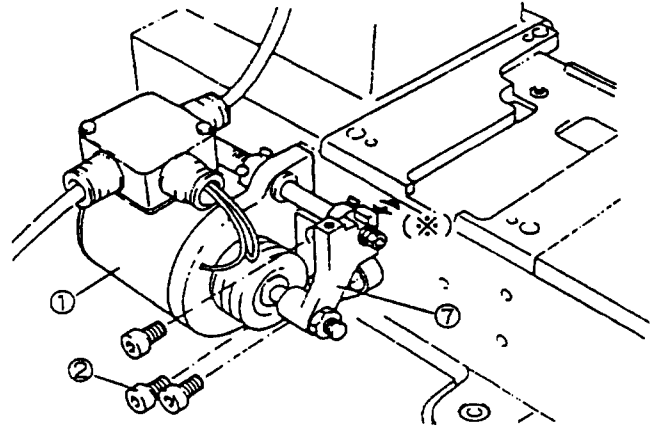

## Installation of Solenoid :

1. Please refer to the drawing and follow the procedure (1) 、(2) , to install the arbor holder (7) of "Solenoid" at the same height as the top of machine body in horizontal. (Refer to the drawing at right)
2. Adjusting trimming of Solenoid - Please take off the rubber cover (3) and loosen the screw (4). to adjust the proper stroke into 17.9 mm by nut (5). Please loosen nut (4) and adjust it by fixed spanner (No. 13)
3. Adjusting the fixed position of solenoid - Please adjust the distance between the end of fixed holder (6) to the end (A) of arbor holder (7) is 117.5 mm. Please double confirm the arbor (7) could move smoothly or not when the spring (8) still didn't fixed up.

# W500, W700

## 電磁閥組與切刀座的連結

Connection of W500, W700 series Solenoid and Lower Trimming Mechanism :

請參考圖示，以螺絲 ⑦ 將連桿 ⑤ 與曲柄 ⑥ 連結。確認各

部分的尺寸(針棒的最頂端) = 手輪上 ⊕ 點的記號處

Please refer to the drawing, To join the connecting rod (5) with crank (6) by screw (7).

and confirm all of distances of each parts relative position are correct. When the needle bar is lifted to the highest position, the point (P) of hand wheel is aligned with the mark of machine body.

1. 安裝的狀態時，Ⓐ 的尺寸為 1mm .
2. 行程之調整，請將軸環 ⑧ 與電磁閥座距離調為 2mm .
3. 活動刀 ⑨ 之移動範圍參照圖示 ① 與針棒中心為 16mm .
4. 活動刀入口位置應為彎針 ⑩ 的中央，請用螺絲 ⑪ 進行調整並固定。
5. 活動刀與固定刀刀刃的交會尺寸為 0.5mm，活動刀刀刃之頂端與固定刀邊緣為 1mm .
6. 彈片後端與下切刀第 ⑫ 鉤下面 ⑬ 的尺寸為 0 .

4. The moving knife is moved along with the middle of looper (10). To be adjusted and fixed it up by screw (11).
5. The engagement of moving knife and fixed knife is 0.5mm. The top edge of moving knife over the edge of fixed knife about 1mm.
6. The top edge of clamp spring is aligned with the edge (F) of moving knife second hook.

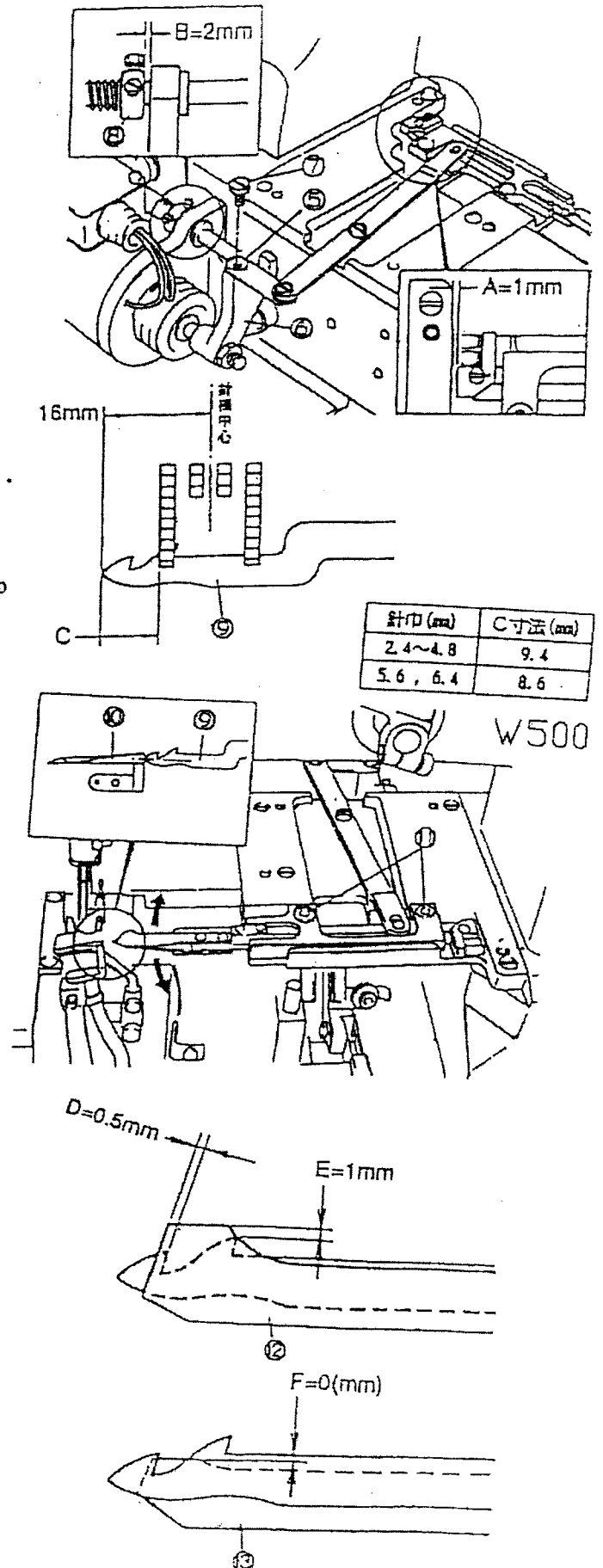

## 鬆線組調整

### Adjustment of Tension Disc Separator

1. W500.700系列的鬆線槓固定座 ⑦, 應從車體的側

面到固定座側面為止約 33 mm 處以螺絲 ② 安裝。

Refer to the tension release lever holder (7) of w500,w700 series, Please install the holder about 33mm from the side of machine body to the side of tension release lever holder by screw(2)

2. 當曲柄 ③ 螺絲 ④ 未完全鎖緊時, 鬆線槓 ⑤ 固定於固定座 ① 之後再與曲柄 ③ 連結。

When loosen the screw (4)of crank (3),to fix the tension release lever (5) on the holder (1)and join with crank (3)

3. W600系列的鬆線槓固定座 ⑦, 應從車體的內側到固定座的側面 10mm 處以螺絲 ⑧ 安裝。

Refer to the tension release lever holder(7) of W600 series, Please fix the holder about 10mm from the side of holder by screw(8)

4. 當鬆線旋鈕與鬆線片 ⑦ 的間隙為 1-1.5mm 時, 請將鬆線槓曲柄 ③ 的螺絲 ④ 鎖緊。

Please keep the clearance of tension adjusting cap and tension disc separator (7) in 1~1.5mm. Then, tighten the screw (4) of crank (3)

5. 軸 ⑨ 在 A 的尺寸為 30 mm 時, 請將螺絲鎖緊。  
The length (A) between the top of "Thread Pull-Off Bar(9)" to the top of "Thread Pull-Off Eyelet Bracket" is 30mm. Then, Tight the screw!!!

◎棉線時, 請調整為 B = 6 mm, C = 7 mm,

D = 8.5 mm, E = 6.5 mm, F = 9 mm,

如使用毛線等具有伸縮性的紗線時, 則請將上述調整稍短些。

When use the S.P. thread, the correctly timing distance for each Pull-Off Hooks are(B)=6MM, (C)=7mm, (D)=8.5mm, (E)=6.5mm, (F)=9mm. If you use the elastic woolly thread, Please shorten the timing distance of each Pull-Off Hook.

◎未能切斷上裝飾線時

請將引線勾 ⑩ (上裝飾線用) 在不影響於線環張力的位置處調整。

When the top thread didn't be cut it out, Please adjust the position of "Top Thread Pull-Off Hook(10) which don't disturb the tension of loop.

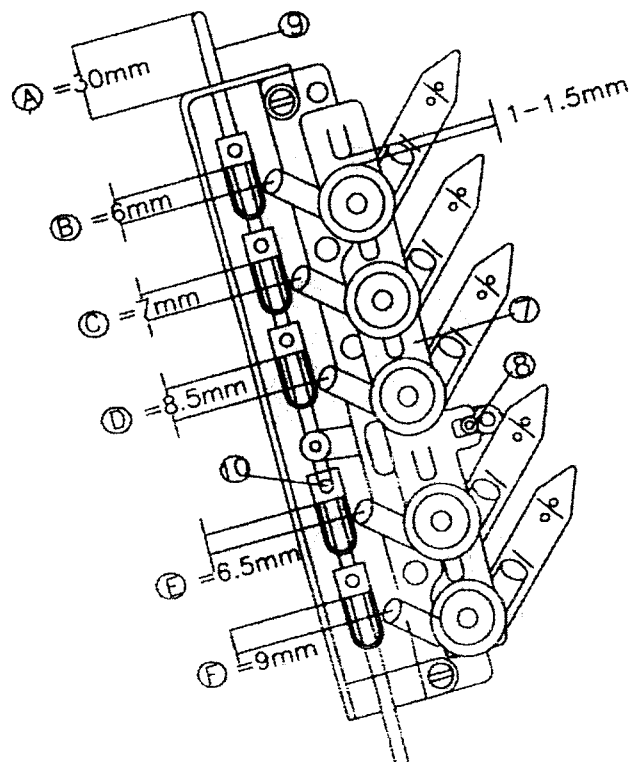
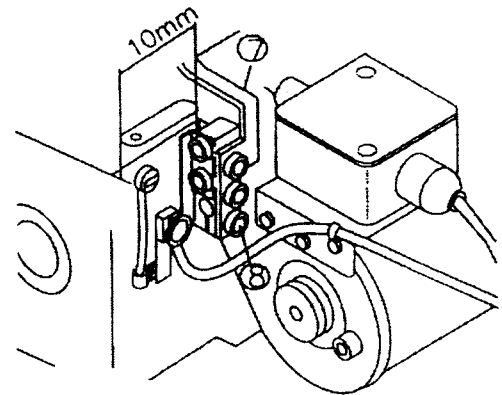
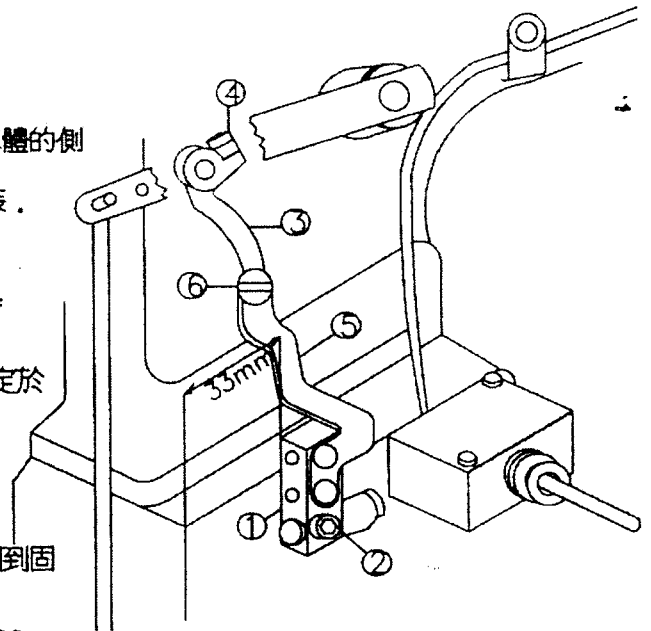

## 安全裝置的調整

### Adjusting Detector Switch

將螺絲 ⑭ 放鬆，並將安全裝置與電磁閥之間間隙調整為0.5mm。

Please release screw (14) to adjust the clearance of detector switch and solenoid into 0.5mm

W500-700

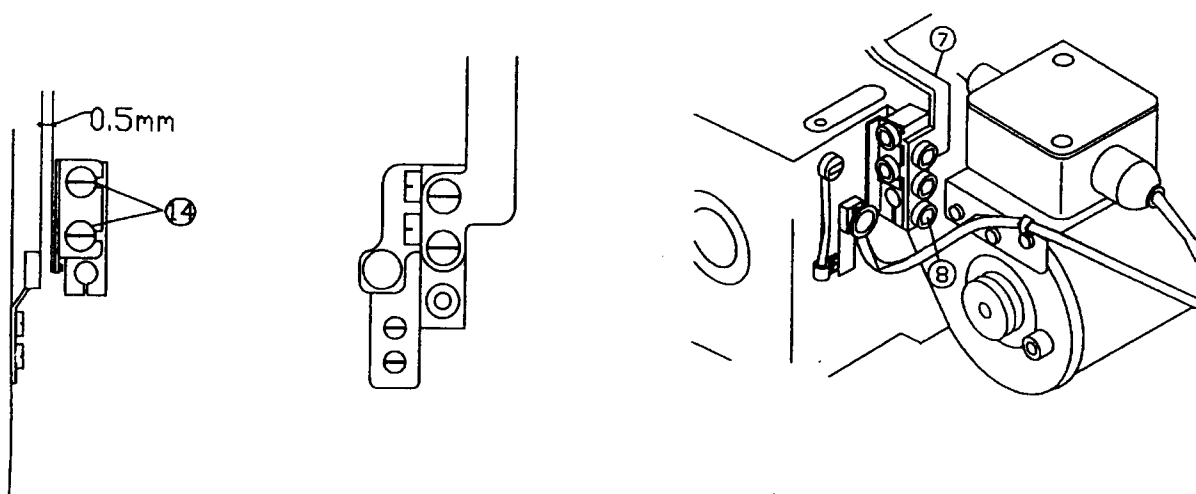



## 壓腳機構安裝

按照右圖圖示將螺絲鎖上。

Installation of Presser Foot Lifter :  
Please follow the right drawing to install  
it up.

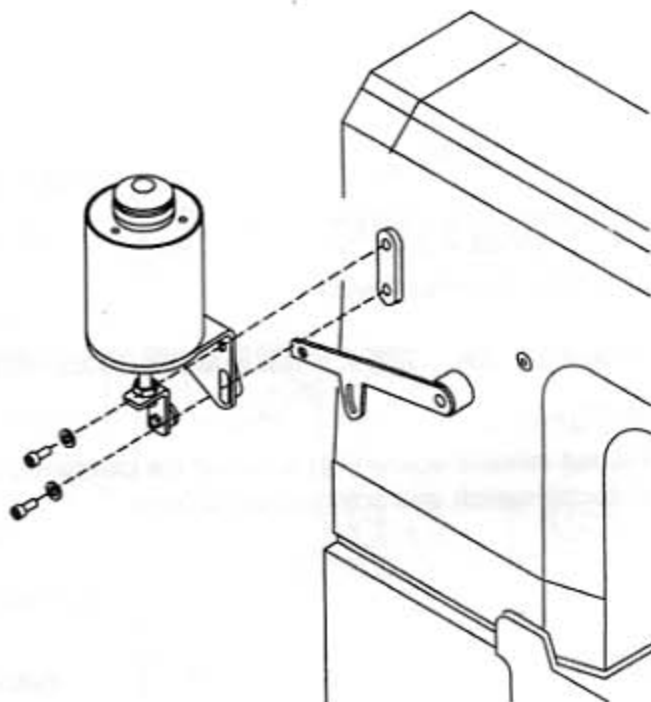

## 壓腳機構調整

1. 鬆開固定螺帽 ② .
2. 依需要高度調整壓腳桿襯片 ① .
3. 鎖緊固定螺帽 ② .

Adjustment of Presser Foot Lifter :

1. Loosen the nut (2).
2. According to requested height to adjust  
Presser Foot Lifter Pushing Block (1).
3. Tighten the nut (2).

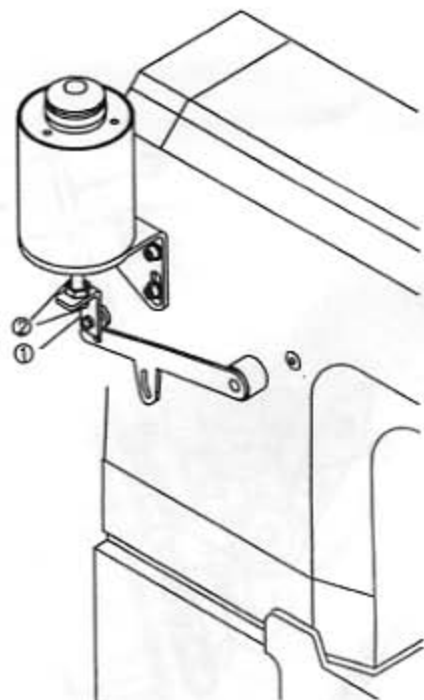

# 電動式撥線組調整

在縫針提升至最高點時

## 1. 撥線組高度：

放鬆螺絲 ① 固定座，將該裝置鉤線臂調至行程最左端（左始點）如圖一，使撥線鉤尖端 ④ 與縫針左端位置高度距離約 0.1mm 如圖二。

## 2. 撥線組方向：

圖示一放鬆螺絲 ② 固定座，使撥線鉤最末端至縫針左端中心距離約 9mm 如圖三。

放鬆螺絲 ③ 固定座，調整撥線鉤尖端 ④ 至縫針尖端後方約 0.3mm~0.8mm 如圖二。

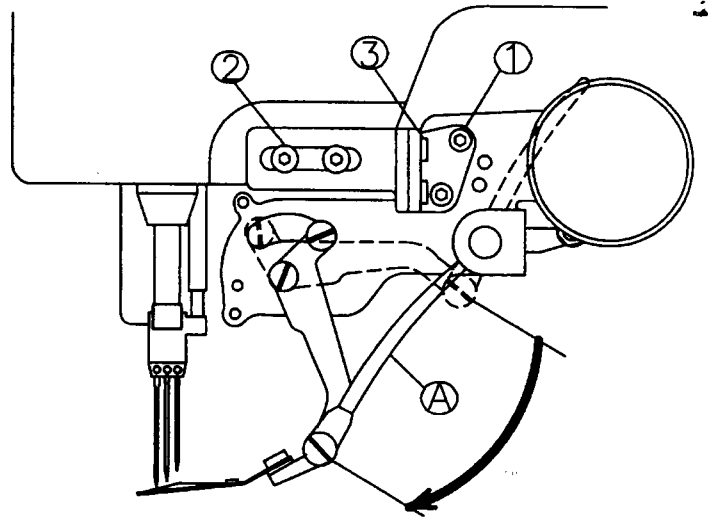

圖一

## Adjustment of Top Electrical Type Thread Wiper :

\*\* Please lift the Needle Bar to the highest point.

### 1. The height of Thread Wiper :

Loosen the screw (1) of Thread Wiper Holder. Then, Move the Wiper Bar (A) to the left dead point of it's stroke. (The left start point as drawing 1)

To adjust the distance between the hook tip of Wiper (B) and the left end height of Needle into 0.1mm. (Drawing 2)

### 2. The direction of Thread Wiper :

Loosen the screw (2) of Thread Wiper Holder. Then, to adjust the distance between the end of Wiper Hook and the center of Left Needle into 9mm as drawing 3.

Loosen the screw (3) of Thread Wiper Holder. Then, to adjust the distance into 0.3mm ~ 0.8mm between the hook tip (B) of Thread Wiper to the rear side of Needle Tip. Please Refer to drawing 2.

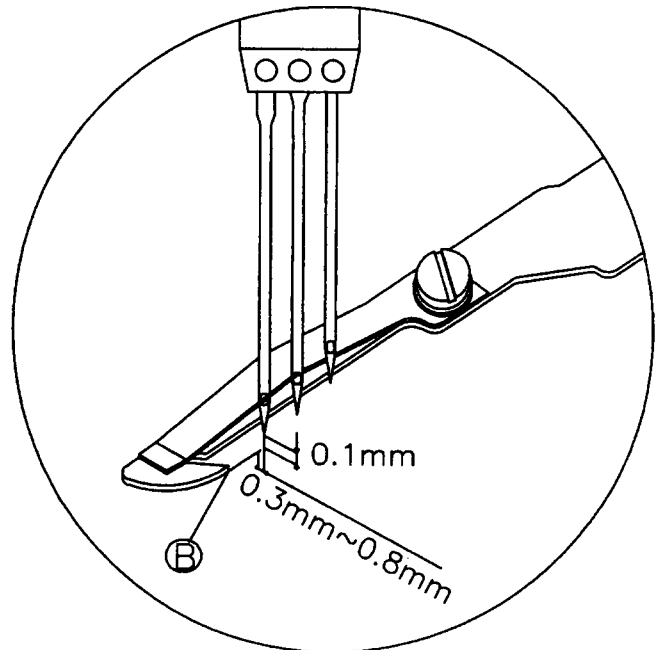

圖二

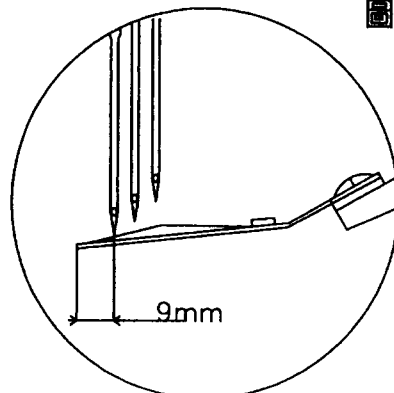

圖三

## 上切刀與固定刀行程的調整

1. 活動刀刀尖 ① 與固定刀邊緣要有0.5mm的間隙。
2. 活動刀被驅動到最低點時，活動刀刀尖 ① 與固定刀下緣需有14.5mm的距離。
3. 調整時可鬆開螺絲 ⑩，移動活動座 ⑨ 做以上調整。
4. 切線後，上飾線需被夾線片 ④ 與活動刀穩穩夾住。
5. 調整時可鬆開螺絲 ⑤，旋轉螺絲 ⑥，使夾線片至適當鬆緊。
6. 放鬆螺絲 ⑦，⑧ 可直接調整切刀的高度及左右的方向，調整至適當距離後鎖緊螺絲 ⑦，⑧。

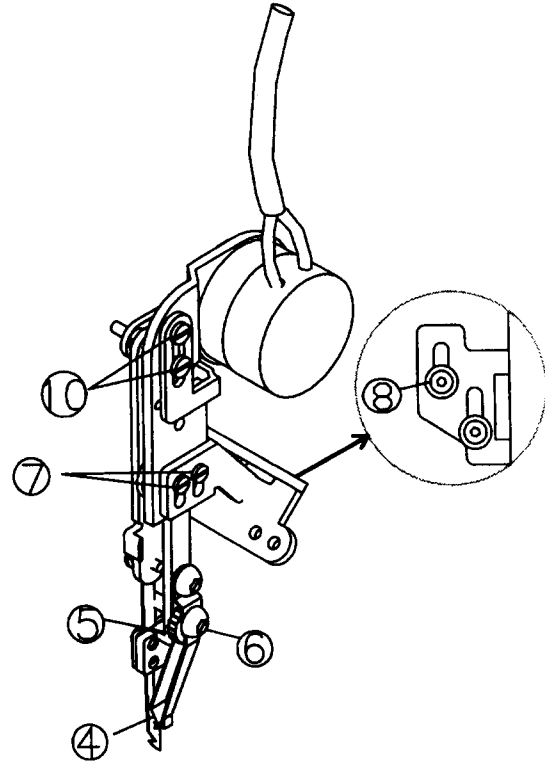

### Adjustment of the stroke of Top Moving Knife and Top Fixed Knife :

1. The clearance between the tip (1) of Top Moving Knife and the edge of Fixed Knife is 0.5mm.
2. Move the Top Moving Knife to the lowest point, The distance is 14.5mm between the tip of Top Moving Knife and the lowest end of Top Fixed Knife.
3. Please loosen the screw (10) and move the Top Trimmer Holder (9) for adjusting the above requested.
4. The Spreader thread has to be clipped in stable by Top Clamp Spring (4) and Top Moving Knife after it be cut.
5. Loosen the screw (5) and turn the screw (6) for adjusting the proper pressure of Top Clamp Spring.
6. Loosen the screw (7) 、(8) for adjusting the height and Right-Left direction of Top Thread Trimmer. Tighten the screw (7) 、(8) after adjusted it.

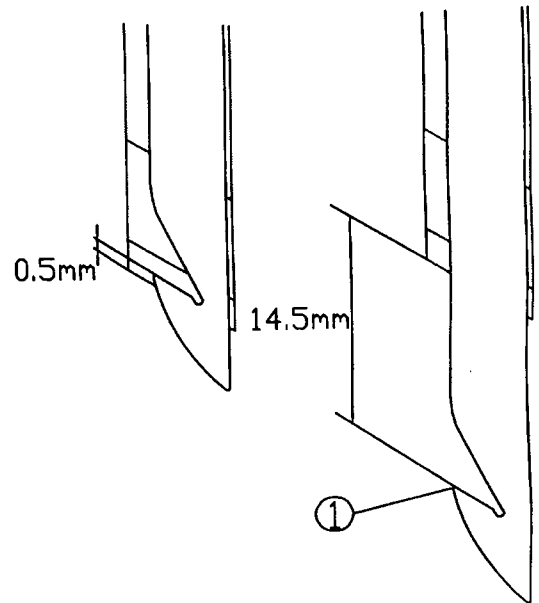

# W500-UT 下切刀

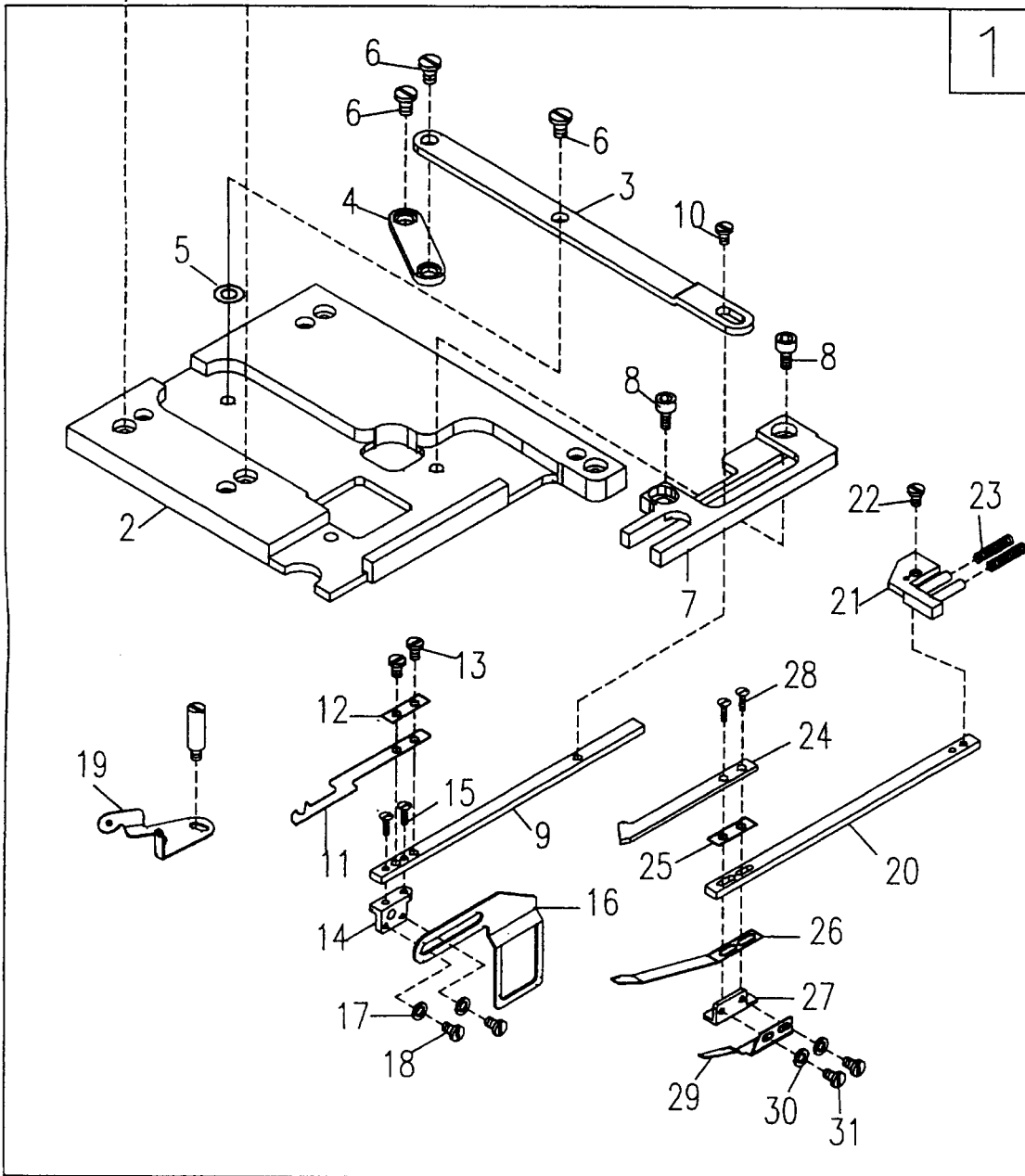
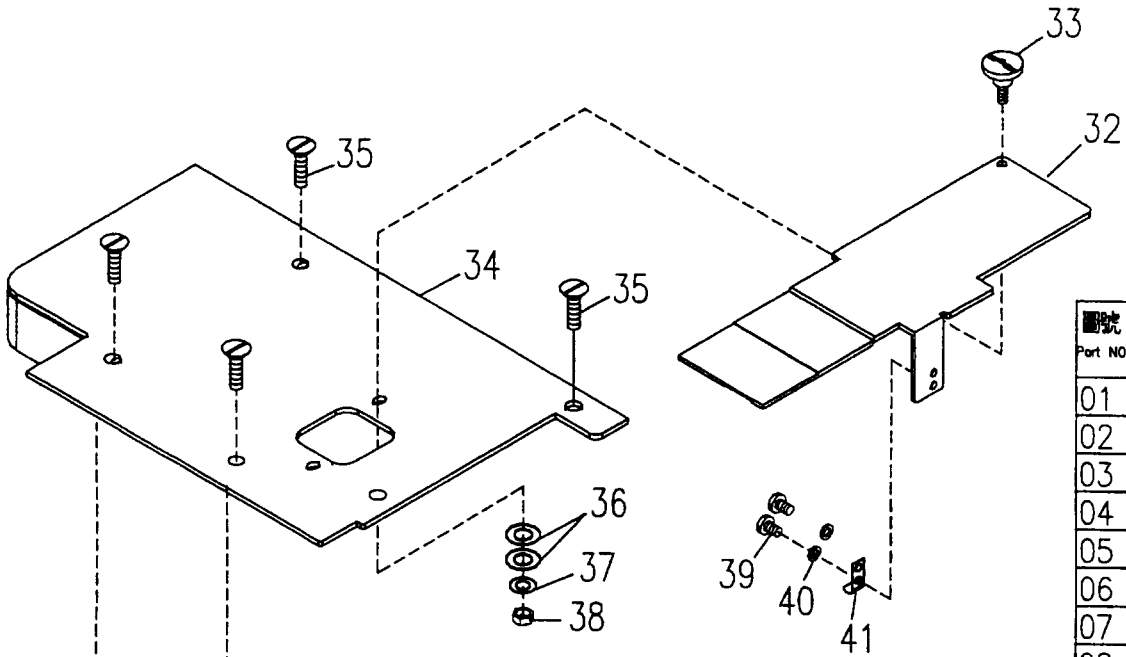

圖號 Part NO.	廠號 CO. NO.	數量 Amt. Req.
01	W5UT01	1set
02	W5UT02	1
03	W5UT03	1
04	W5UT04	1
05	W5UT05	1
06	W5UT06	3
07	W5UT07	1
08	W5UT08	2
09	W5UT09	1
10	W5UT10	1
11	W5UT11	1
12	W5UT12	1
13	W5UT13	2
14	W5UT14	1
15	W5UT15	2
16	W5UT16	1
17	W5UT17	2
18	W5UT18	2
19	W5UT19	1
20	W5UT20	1
21	W5UT21	1
22	W5UT22	1
23	W5UT23	2
24	W5UT24	1
25	W5UT25	1
26	W5UT26	1
27	W5UT27	1
28	W5UT28	2
29	W5UT29	1
30	W5UT30	2
31	W5UT31	2
32	W5UT32	1
33	W5UT33	1
34	W5UT34	1
35	W5UT35	4
36	W5UT36	2
37	6M004	1
38	7M004	1
39	W5UT39	2
40	W5UT40	2
41	W5UT41	1

# W500E

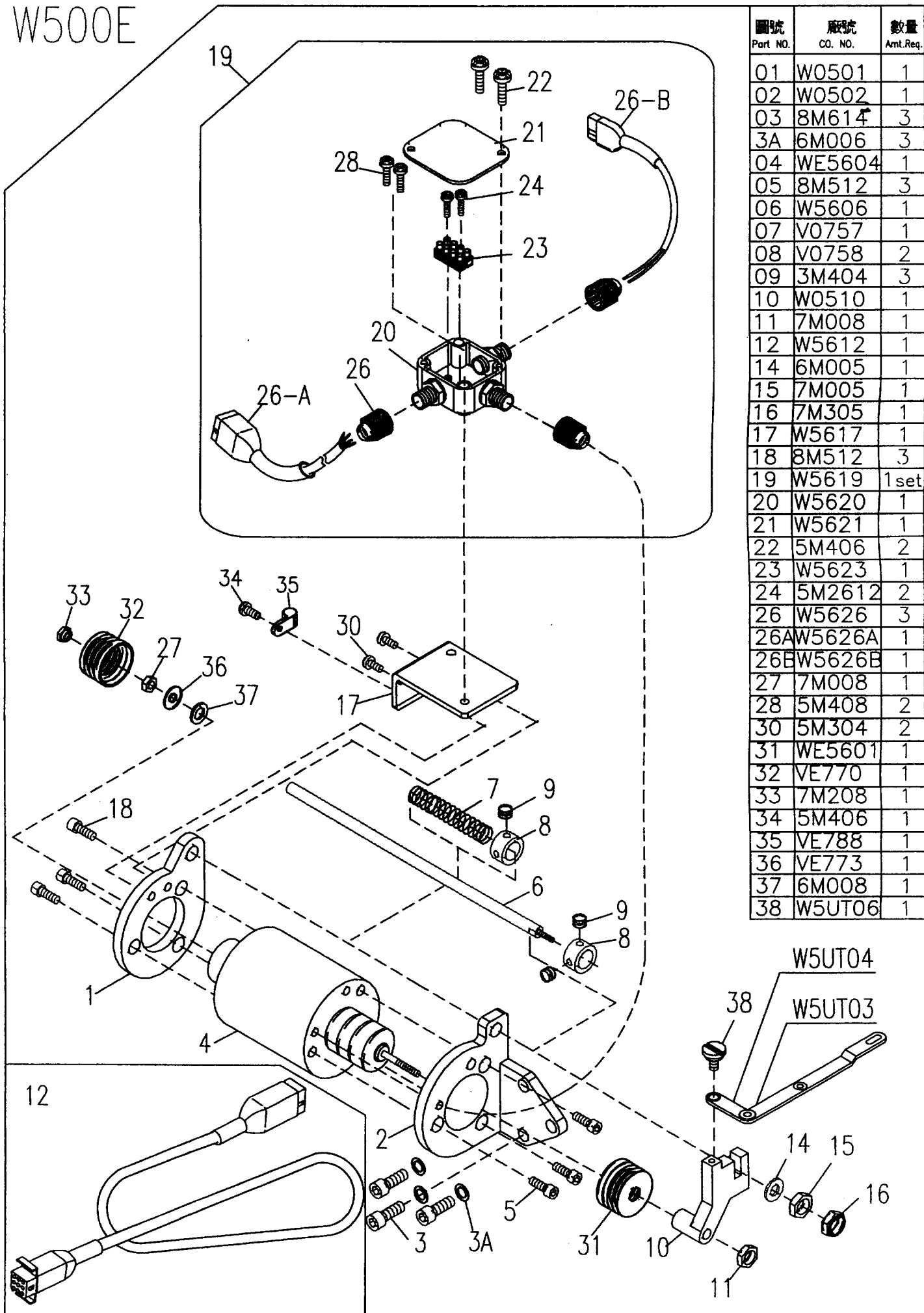

圖號 Part NO.	廠號 CO. NO.	數量 Amt. Req.
01	W0501	1
02	W0502	1
03	8M614	3
3A	6M006	3
04	WE5604	1
05	8M512	3
06	W5606	1
07	V0757	1
08	V0758	2
09	3M404	3
10	W0510	1
11	7M008	1
12	W5612	1
14	6M005	1
15	7M005	1
16	7M305	1
17	W5617	1
18	8M512	3
19	W5619	1set
20	W5620	1
21	W5621	1
22	5M406	2
23	W5623	1
24	5M2612	2
26	W5626	3
26A	W5626A	1
26B	W5626B	1
27	7M008	1
28	5M408	2
30	5M304	2
31	WE5601	1
32	VE770	1
33	7M208	1
34	5M406	1
35	VE788	1
36	VE773	1
37	6M008	1
38	W5UT06	1

W5UT04

W5UT03

W500E-TP

E56

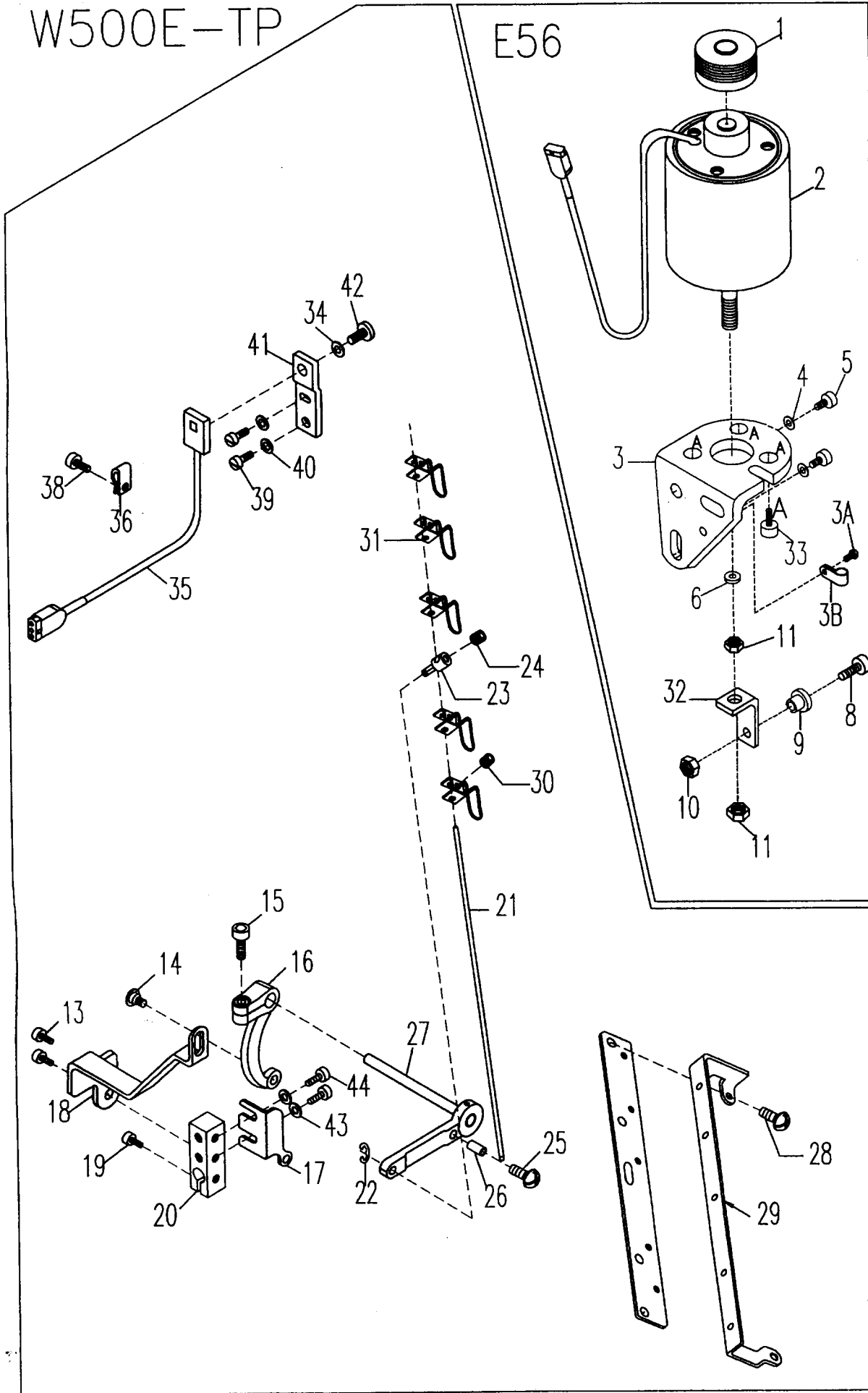

圖號 Part NO	廠號 CO. NO.	數量 Amt. Req
01	WE5601	1
02	WE5602	1
03	WE5603	1
3A	5M406	1
3B	V0768	1
04	6M006	2
05	8M614	2
06	WE5606	1
08	8M512	1
09	W5609	1
10	7M005	1
11	7M008	2
13	8M512	2
14	W5614	1
15	8M512	1
16	W5616	1
17	W0517	1
18	W0518	1
19	8M512	1
20	W0543	1
21	V0013	1
22	9M004	1
23	V0020	1
24	3M404	1
25	5M415	1
26	V0024	1
27	W5627	1
28	5M405	2
29	W5629	1
30	3M304	5
31	V0017	5
32	WE5608	1
33	8M512	3
34	6M14.5	1
35	W5635	1
36	V0788	1
38	5M406	1
39	5M406	2
40	6M004	2
41	W0541	1
42	1M6411	1
43	6M005	2
44	8M512	2
	E56	1 set

# ST-E 上切刀

33

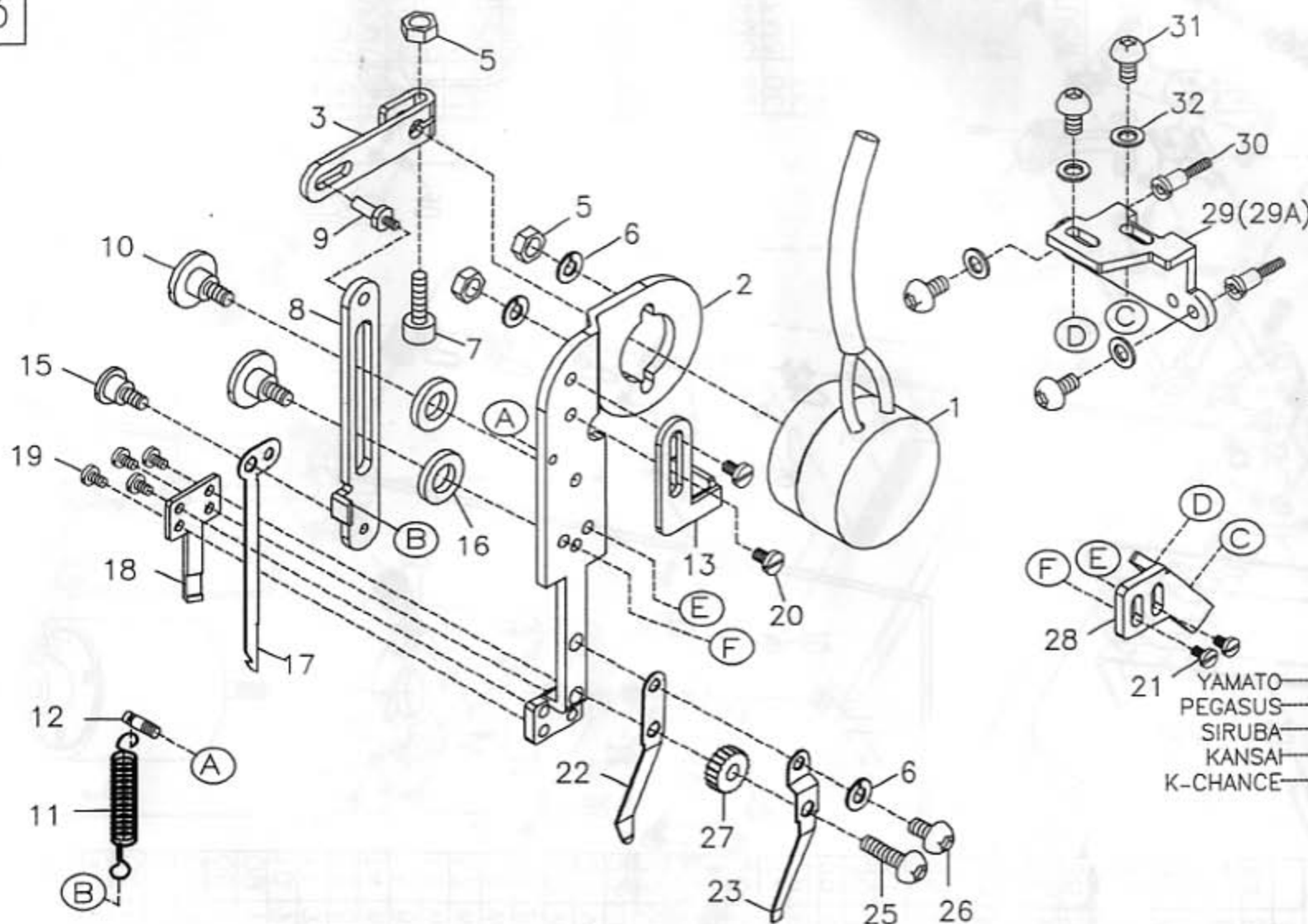

圖號 Part NO.	廠號 CO. NO.	數量 Amt./Req.
01	STE01	1
02	STE02	1
03	STE03	1
05	7M003	3
06	6M203	2
07	8M314	1
08	STE08	1
09	STE09	1
10	STE10	2
11	STE11	1
12	STE12	1
13	STE13	1
15	ST015	1
16	STE16	2
17	ST017	1
18	ST018	1
19	VCUT26	4
20	1M6409	2
21	ST021	2
22	ST022	1
23	ST023	1
25	2M308	1
26	2M304	1
27	ST027	1
28	ST028	1
29	ST029	1
30	ST30Y	2
	YAMATO	
	PEGASUS	ST30P
	SIRUBA	ST30S
	KANSAI	ST30K
	K-CHANCE	ST30C
31	2M408	4
32	6M004	4
33	ST-E	1 set
29A	ST029A	1
	VF2500	
FOR	FG666	

# Wiper-37

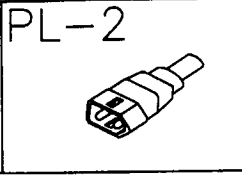
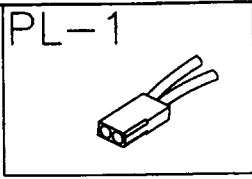
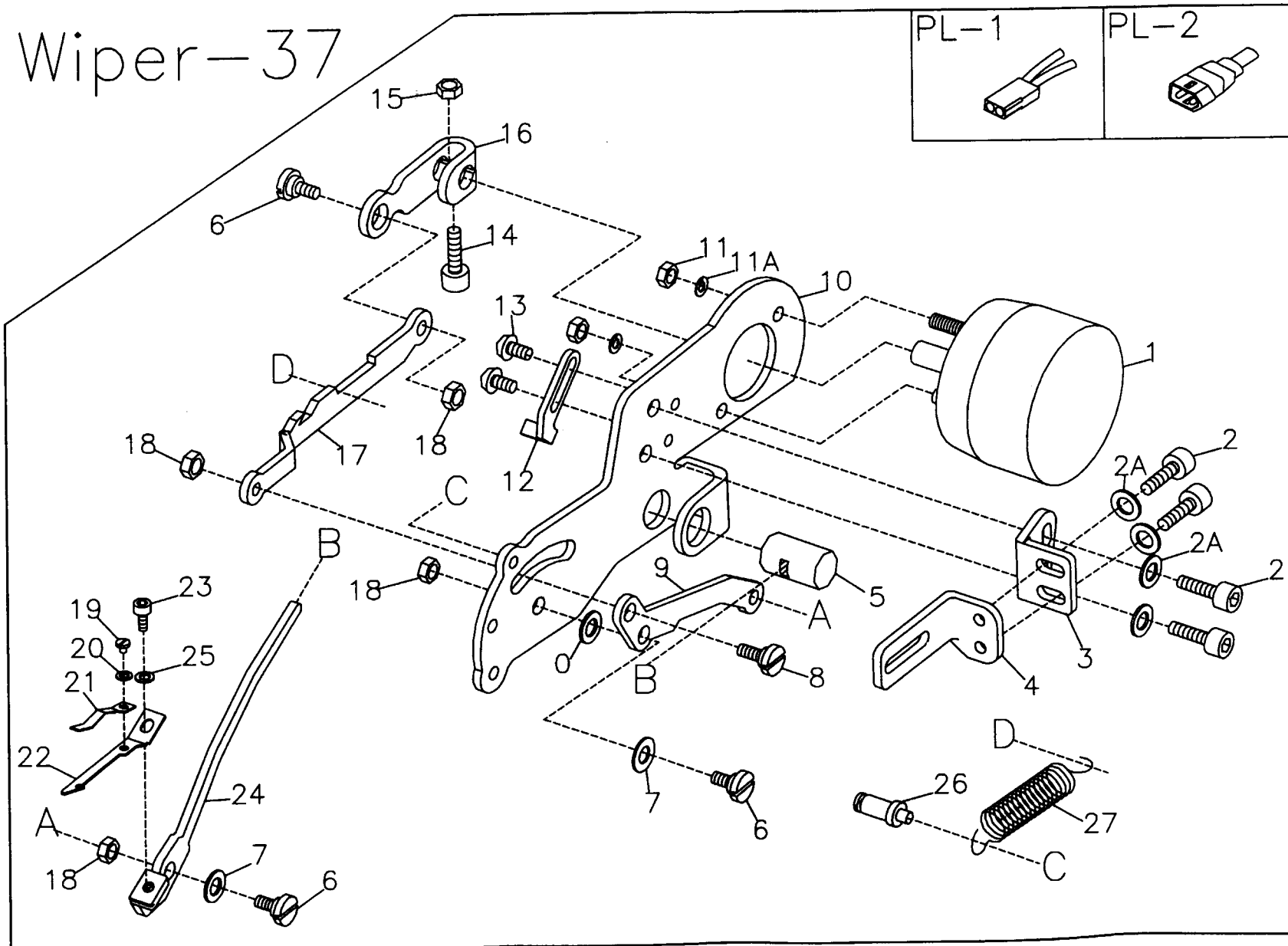

圖號 Part NO.	廠號 CO. NO.	數量 Amt./Req.
00	W6UT09	1
01	WP3701	1
02	8M406	4
2A	6M004	4
03	WP3703	1
04	WP3704	1
05	WP3705	1
06	WP3706	3
07	6M005	2
08	WP3708	1
09	WP3709	1
10	WP3710	1
11	7M003	2
11A	6M203	2
12	WP3712	1
13	2M304	2
14	8M312	1
15	7M003	1
16	WP3716	1
17	WP3717	1
18	7M004	4
19	VCUT34	1
20	6M12.3	1
21	WP3721	1
22	WP3722	1
23	8M304	1
24	WP3724	1
25	6M103	1
26	WP3726	1
27	WP3727	1
37	WP-37	1 set
	PL-1	1
	PL-2	1



## 上切刀與固定刀行程的調整

1. 活動刀刀尖 ① 與固定刀邊緣要有0.5mm的間隙。
2. 活動刀被驅動到最低點時，活動刀刀尖 ① 與固定刀下緣需有14.5mm的距離。
3. 調整時可鬆開螺絲 ⑩，移動活動座 ⑨ 做以上調整。
4. 切線後，上飾線需被夾線片 ④ 與活動刀穩穩夾住。
5. 調整時可鬆開螺絲 ⑤，旋轉螺絲 ⑥，使夾線片至適當鬆緊。
6. 放鬆螺絲 ⑦，⑧ 可直接調整切刀的高度及左右的方向，調整至適當距離後鎖緊螺絲 ⑦，⑧。

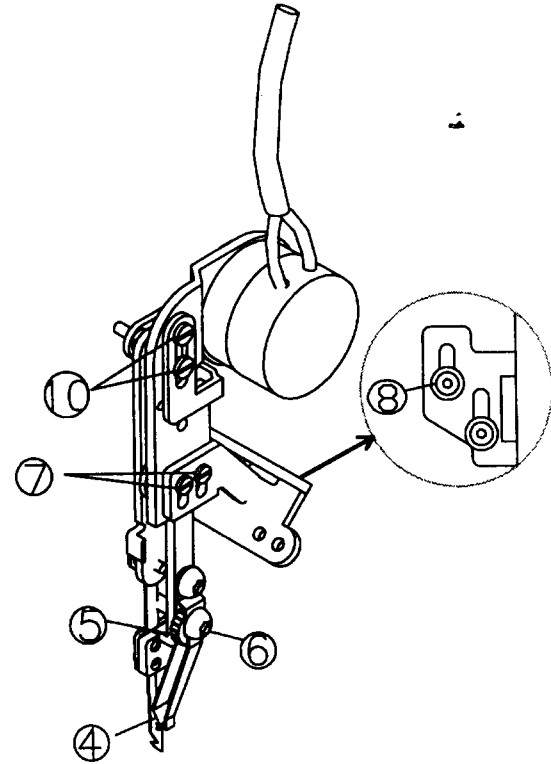

### Adjustment of the stroke of Top Moving Knife and Top Fixed Knife :

1. The clearance between the tip (1) of Top Moving Knife and the edge of Fixed Knife is 0.5mm.
2. Move the Top Moving Knife to the lowest point, The distance is 14.5mm between the tip of Top Moving Knife and the lowest end of Top Fixed Knife.
3. Please loosen the screw (10) and move the Top Trimmer Holder (9) for adjusting the above requested.
4. The Spreader thread has to be clipped in stable by Top Clamp Spring (4) and Top Moving Knife after it be cut.
5. Loosen the screw (5) and turn the screw (6) for adjusting the proper pressure of Top Clamp Spring.
6. Loosen the screw (7) 、(8) for adjusting the height and Right-Left direction of Top Thread Trimmer. Tighten the screw (7) 、(8) after adjusted it.

